

MOBILE TROLLEY

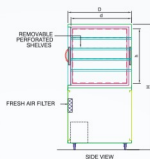
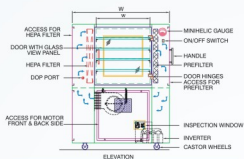

INTERNAL DIMENSIONS			EXTERNAL DIMENSIONS		
w	d	h	W	D	H
610	685	620	1100	720	1420
915	990	620	1405	1025	1420
1000	685	620	1490	720	1420

Sr.No	Item	Description
1)	MOC	SS 304 / SS 316 / Customised
2)	HEART OF SYSTEM COMPRISES OF	
2.1		Imported Miniplate HEPA Filter with hot melt technology, which conforms to EU-13 / EU-14 Grade at supply position
2.2		Fabtech make Return Air prefilter which conforms to EU 6 Grade, with efficiency of 95% down to 5 μ .
2.3		Motor Blower provided are statically and dynamically balanced, Sufficient capacity and static pressure is maintained to take care of airflow requirement for entire life to HEPA.
2.4		Dwyer Make Minihelic Gauge
2.5		ON/OFF Switches for motor & Lights.
2.6		SS 304 double walled doors, SS handles, hinges
2.7		Return Air Grills on side walls.
2.8		Electro – Magnetic Interlocking to ensure only one side door will be opened at a time
2.9		DDP Test Port at upstream of HEPA filter
3)	PERFORMANCE	
3.1	Air cleanliness	ISO Class 5 (ISO 14644-1:1999 (E))
3.2	Air Velocities	0.45 \pm 0.05 mps
3.3	Air Flow	Vertical Recirculatory
3.4	Noise Level	Less than 67 dB on Scale 'A' when Ambient is not greater than 55dB on Scale 'A'
3.5	Vibration Level	Minimum
4)	POWER SUPPLY	230 V AC 1- ϕ 50HZ

STATIC PASS BOX (FLOOR MOUNTED)

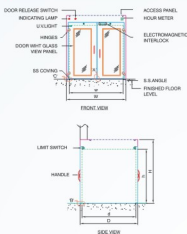

INTERNAL DIMENSIONS			EXTERNAL DIMENSIONS		
w	d	h	W	D	H
1000	1000	1000	1100	1070	1200
1050	1050	1050	1150	1120	1250
1200	1200	1500	1300	1270	1700

STATIC PASS BOX (WALL MOUNTED)

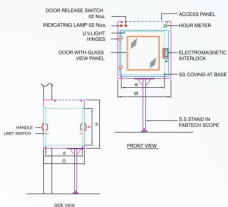

INTERNAL DIMENSIONS			EXTERNAL DIMENSIONS		
w	d	h	W	D	H
600	600	600	740	670	800
620	600	700	760	670	850
800	900	1000	940	970	1150

Sr.No	Item	Description
1)	MOC	SS 304 / SS 316 / Customised
2)	HEART OF SYSTEM COMPRISES OF	
2.1		SS 304 double walled doors with glass view panels, SS handles, hinges
2.2		Electro – Magnetic Interlocking to ensure only one side door will be opened at a time
2.3		indicating Lamp on both sides
2.4		Door release button on both sides
3)	POWER SUPPLY	230 V AC 1-ø 50HZ

Optional Accessories

- Mechanical Interlocking
- U. V. Light with Hour Meter with interlocking arrangement to put-off U.V. Light if either door opens
- Support stand to mount the pass box on wall
- Flange for sealing the gap between the pass box and the cleanroom wall
- Flame Proof Fitting